



Food Ingredients & Technology

FIT-Filter trolley 40R-S-SP

Codes 15440L and 15440XL

Manual

WARNING: Filtering hot oil can cause burns. Handle with care and wear protective clothing!



The FIT-Filter trolley is designed for filtration of frying oil. Daily filtration removes pollution from used frying oil. Damaging burned particles are removed during filtration and cleaner oil is the result. Filter aids can improve the filtration result.

Technical:

Electricity Pump: 220-230 V, 50 Hz

Power Pump: 0,12 kW

Pump maximum temperature: 180⁰ C

Pump overpressure safety set at: 3 Bar

Pump volume: 11 liter/minute

Volume filter tank: 42 liter

Height filter tank: 320mm

Dimensions trolley without return pipe (HxLxW): 870x500x460mm

Return pipe (HxL): 680x730mm

Filtration Procedure:

Add filter aid on the filterscreen on the bottom of the tank. Place the protection plate in the trolley. Position the trolley in front of the fryer with the drain of the fryer emptying in the filter tank and the return pipe above the frying vat. Drain the hot oil in the filter tank. Start the pump and circulate the oil over the frying vat with the oil drain still open for around 5-6 minutes. Rinse small particles and debris from the fryer with the return oil from the return pipe while circulating. Close the drain when ready and fill the fryer.

Cleaning:

Remove filter aid and debris daily after cooling down.

To keep the filterscreen open the screen should be removed from the trolley every week or second week to be cleaned. This can be done by loosening the lock nut on the screen and take the filterscreen out of the trolley. Open the frame around the screen with the thumb knobs. All parts of the filterscreen (2x frame (nr 1), 1x stainless steel bottom plate (nr 4), 1x insert (nr 3, 1x mesh screen (nr 2)) can be cleaned, assembled and placed back in the trolley.

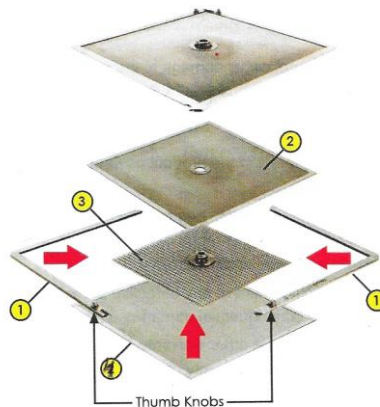

Clean the filter trolley when wanted.

Always rinse all surfaces with water and a little vinegar after cleaning to remove and neutralize soap residue.



Food Ingredients & Technology

Parts FIT-Filter trolley 40R-S-SP

Part name	Part code
Trolley tank housing	15.100.01
Trolley handle bar	15.100.02
Trolley pump housing	15.100.03
Trolley wheel	15.100.04
Trolley wheel with break	15.100.05
Protection plate	15.100.06
Return pipe	15.100.07
Protection sleeve short 450mm	15.100.08
Protection sleeve long 620mm	15.100.09
Flexible hose knee 3/8-1/2in + 3/8-3/8in Lhart=390mm	15.100.10
Electric box	15.100.11
Electric wire	15.100.12
On/Off button	15.100.13
Butto holder	15.100.14
Electric connector	15.100.15
Wire holder	15.100.16
Mesh screen	15.800.01
Filter Insert	15.800.02
Filter frame	15.800.03
Bottom Plate	15.800.04
Lock nut ½ metric	15.000.01
SS Quick release coupling ½ out metric	15.000.09
SS Pump 11L	15.000.11
Pipe nipple 3/8- 60mm	15.000.15
Knee 3/8in-1/2in	15.000.16
Wire nipple 3/8	15.000.17
Connection nipple 3/8in-1/2in	15.000.18